

Adding additional Accounts to your SmartHub

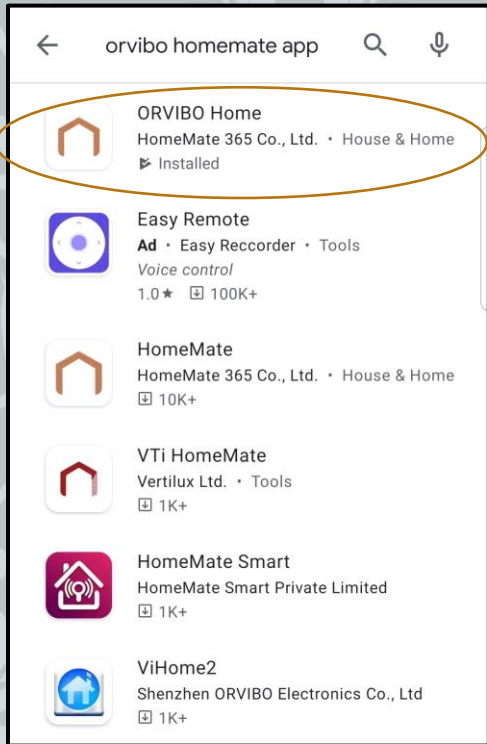

1 Using the phone to be added: Search for "Orvibo Home" in Play/APP Store



2 Install App

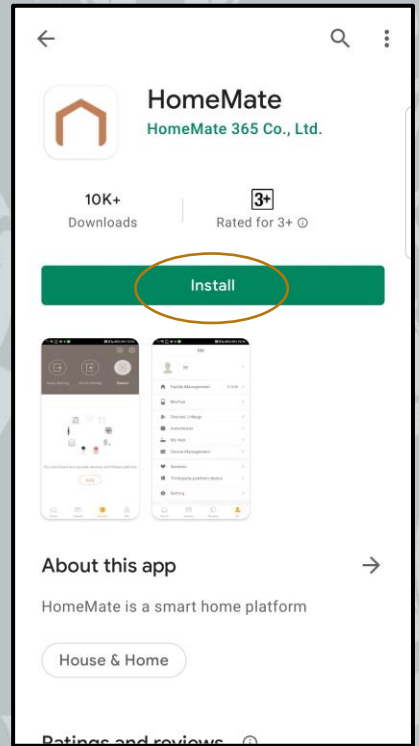

3 Select allow

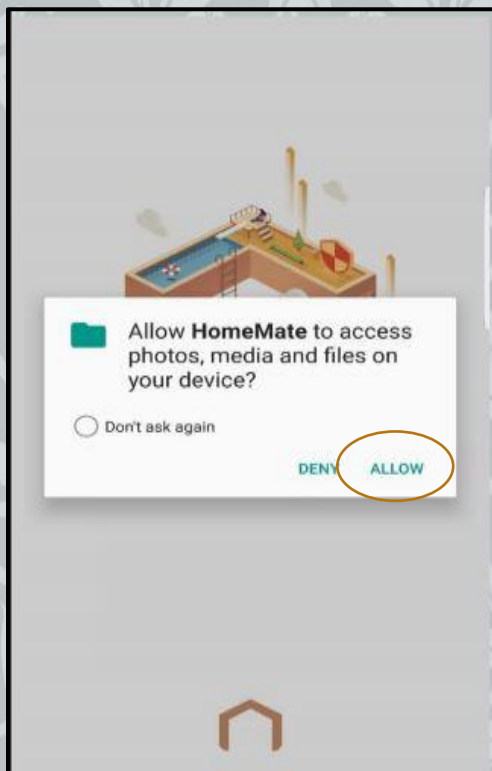

4 Sign up using an email address and password and confirm

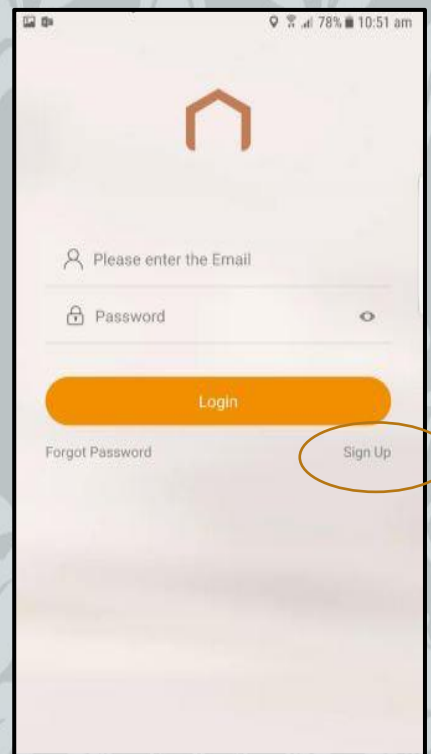

5 Using the mobile phone of the administrator open the OrviboHome App and select 'Me'

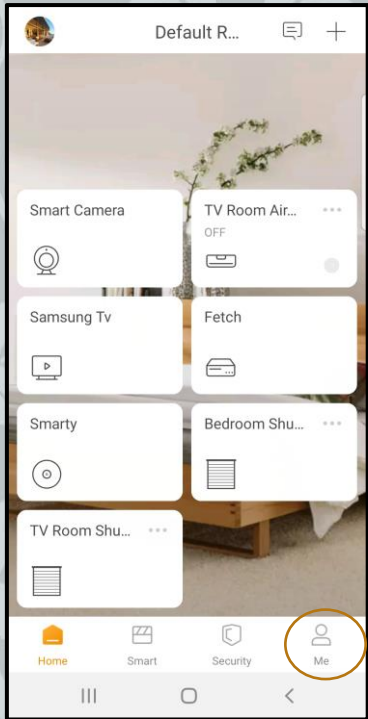

6 Select Family Management

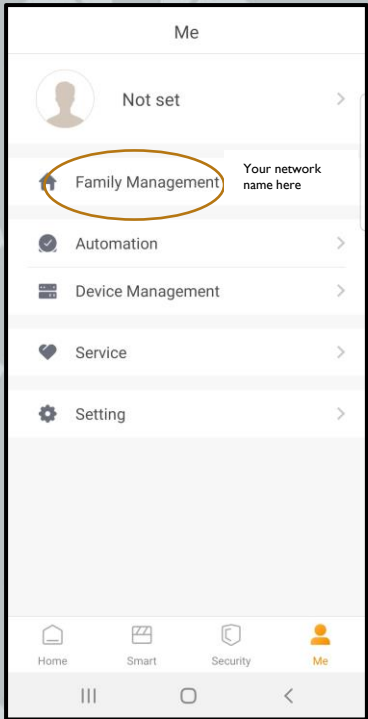

7 Select Member Permission

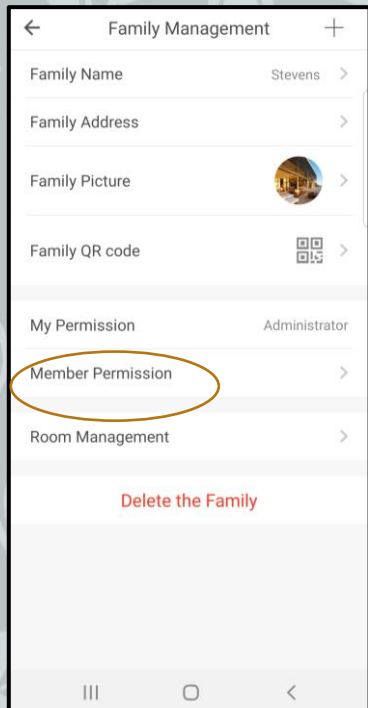

8 Select the add member symbol

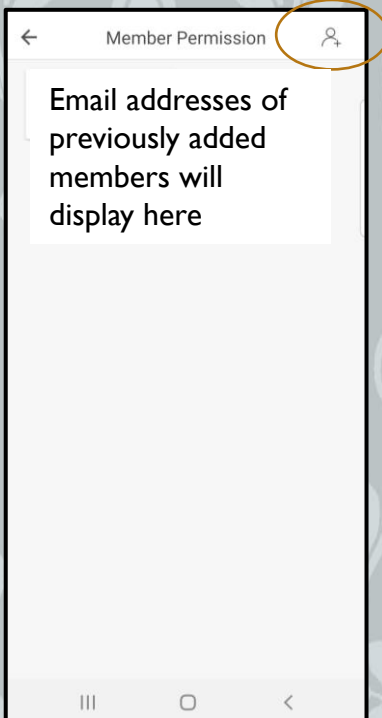

9 Enter the email address they used to sign up to the app, then select their access level before hitting invite

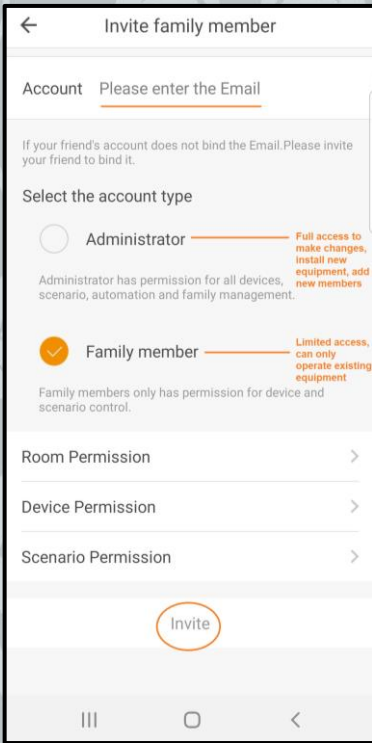

10 On the invited persons phone they will receive a notification to accept the invitation

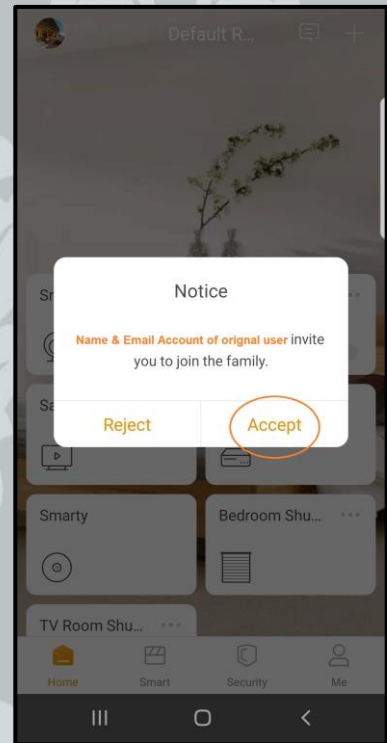

11 If you have a Zigbee Hub previously installed it will prompt you to add the Hub

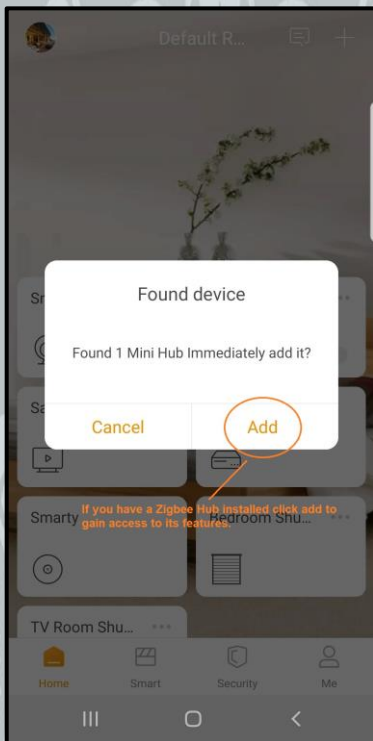

12 Select add to finalise Procedure. Enjoy the use of your new SmartHub

